

## Instructions for Models:

SA-1 402  
SA-1 402-BN  
SA-1 402-PN

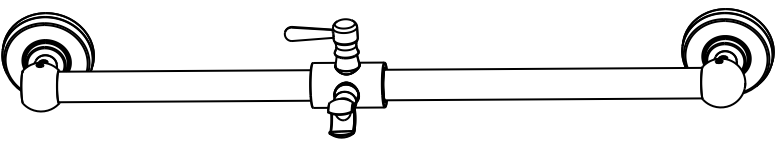

## Need Help?

For additional assistance or service call:

**SPEAKMAN** Company  
400 Anchor Mill Road  
New Castle, DE 19720

PHONE: 800-537-2107

EMAIL: [customerservice@speackmancompany.com](mailto:customerservice@speackmancompany.com)

WEB: [www.speackmancompany.com](http://www.speackmancompany.com)

92-3332-R1

## What You Need To Know:

### Tools:

#### Required:

\*Phillips Screwdriver

\*Pencil

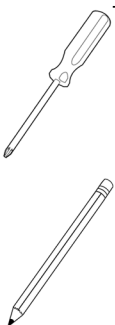

\*Drill with 1/4" Bit

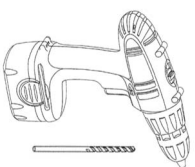

#### Helpful:

\* 1/4" Tile Drill Bit

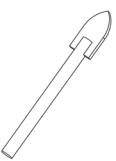

\*Level



### Important Notes:

Be sure to read instructions thoroughly before beginning installation. Do not overtighten any connections or damage may occur.

### Safety Tips:

This item is NOT designed for use as a grab bar. Do not mount in locations where product is likely to be used as a grab bar.

Use caution when drilling into walls to avoid electrical and plumbing lines hidden within wall.

### Maintenance:

Clean with a soft, damp cloth only. Do not use scrub pads, detergents or cleansers as they may harm the protective finish of your Slide Bar

1

Place Slide Bar assembly on to wall in the desired mounting position. Take care that the Slide Bar is oriented in a vertical position. Using a pencil, lightly trace outline of end brackets on to wall.

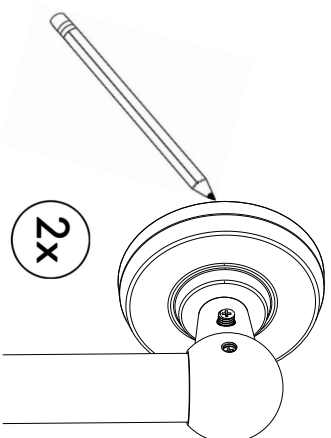

2x

2

Slide flange off Mounting Bracket. Then loosen set screw and remove Mounting Bracket from Slide Bar Assembly.

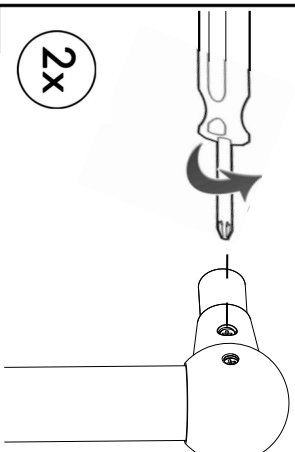

2x

3

Mark center of mounting locations (2) with a pencil.

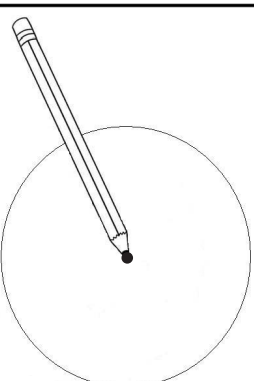

2x

4

Drill 1/4" hole in marked locations. If drilling into tile, be sure to use a drill bit designed for tile. If mounting directly into stud or wood wall, secure lower end bracket to wall with mounting screw without drilling hole.

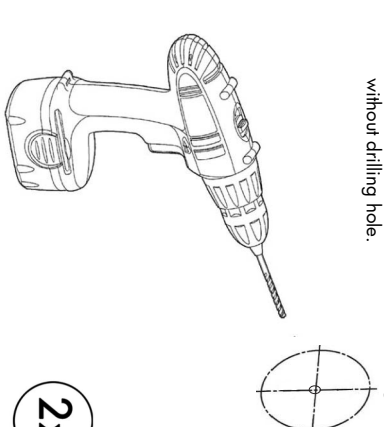

2x

5

Insert Plastic Anchors into drilled hole and press in until flush with wall. Secure Mounting Brackets and Flange to wall with Mounting Screws using Phillips Screwdriver.

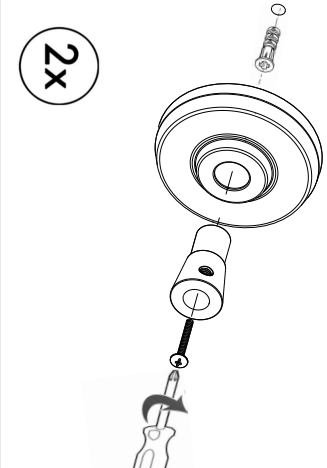

2x

6

Install Slide Bar assembly over Mounting Brackets, and secure with Set Screws using Flathead Screwdriver.

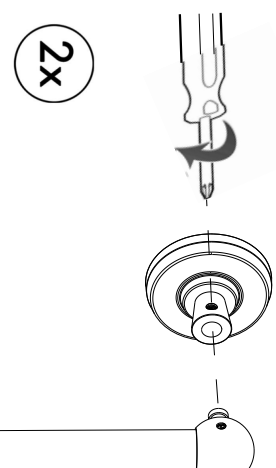

2x

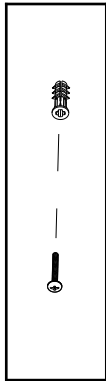
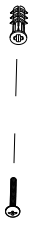

RPG05-0888

M6 THREAD  
SET SCREW

